

TRANSFORMADORES DE CORRENTE (TCs)

Características Técnicas:

- Corrente Secundária Nominal: 5A
- Instalação: Abrigada
- Isolação a seco: Encapsulamento em termoplástico
- Tensão máxima de isolamento: 3kV
- Classe de temperatura: B (máx. 130°C)
- Normas Fabric.: IEC185-1987, VDE0414 e BS7626
- Tensão Máxima (eficaz): 0,67kV
- Frequência: 50/60Hz
- Fator Térmico Nominal: 1,2In
- Polaridade: Substrativa
- Corrente térmica (1s): 60In
- Corrente dinâmica (0,5 seg.): 150In
- Temperatura: do ar ambiente: máximo de 70°C

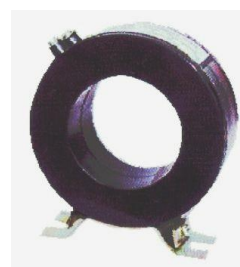

Corrente Primária (A)	Modelo	Invólucro	Carga Nominal (VA)	
30	STC-J1 30/5A	Tipo 1	5	2,0 C 5,0
50	STC-J1 50/5A	Tipo 1	5	2,0 C 5,0
100	STC-J1 100/5A	Tipo 1	5	1,6 C 5,0
150	STC-J1 150/5A	Tipo 1	5	1,2 C 5,0
200	STC-J1 200/5A	Tipo 1	5	1,0 C 5,0
300	STC-J2 300/5A	Tipo 2	10	1,0 C 10,0
400	STC-J2 400/5A	Tipo 2	10	1,0 C 10,0
500	STC-J2 500/5A	Tipo 2	15	1,0 C 15,0
600	STC-J3 600/5A	Tipo 3	15	1,0 C 15,0
700	STC-J3 700/5A	Tipo 3	15	1,0 C 15,0
800	STC-J3 800/5A	Tipo 3	15	1,0 C 15,0
1000	STC-J4 1000/5A	Tipo 4	20	1,0 C 20,0
1200	STC-J4 1200/5A	Tipo 4	20	1,0 C 20,0
1600	STC-J4 1600/5A	Tipo 4	20	1,0 C 20,0
1600	STC-J5 1600/5A	Tipo 5	15	1,0 C 15,0
2000	STC-J5 2000/5A	Tipo 5	15	1,0 C 15,0
2500	STC-J5 2500/5A	Tipo 5	15	1,0 C 15,0
3000	STC-J5 3000/5A	Tipo 5	15	1,0 C 15,0

TRANSFORMADORES DE CORRENTE (TCs)

Encapsulamentos:

Tipo1

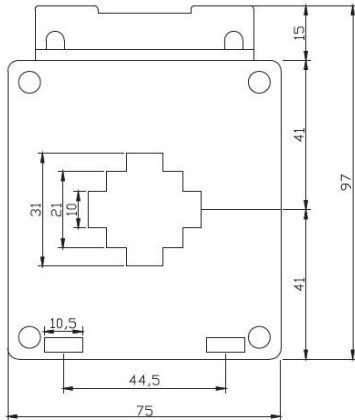

Tipo2

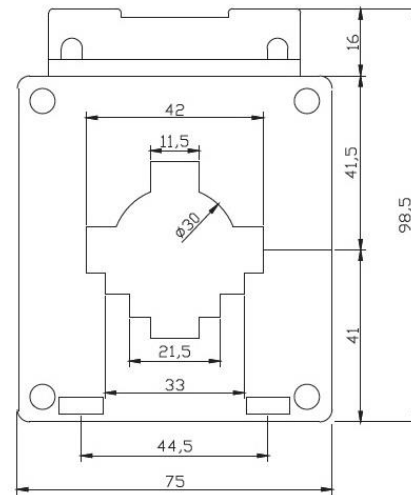

Tipo3

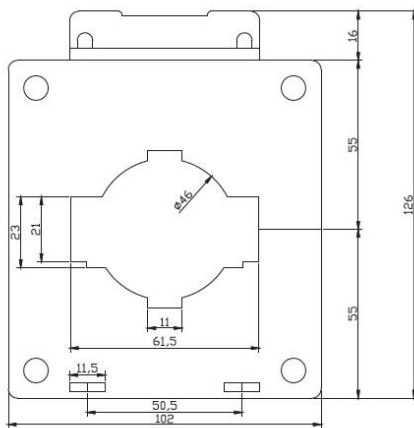

Tipo4

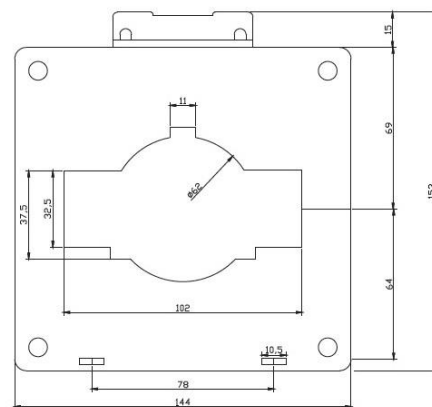

Tipo5

